

# MODULAR<sup>TM</sup> PRO



<http://myanmar-home-design.com>

✉ [info@myanmar-home-design.com](mailto:info@myanmar-home-design.com)

☎ 09 36 131 465 - 09 767 494 821

f [myanmar.home.design](https://www.facebook.com/myanmar.home.design)



# For every sector



## Wide technical expertise

- Remote site  
Life Camp installations  
Emergency & relief facilities
- Power Rooms  
In-plant facilities  
Restrooms
- Workshops  
Warehouse & storage  
Security booth
- Data center  
Laboratories  
Clean rooms

## Fast & flexible

### Quickly deployed

- Easy to mobilize & to relocate
- Modules with standard shipping sizes
- Extendable / up to 4 storeys

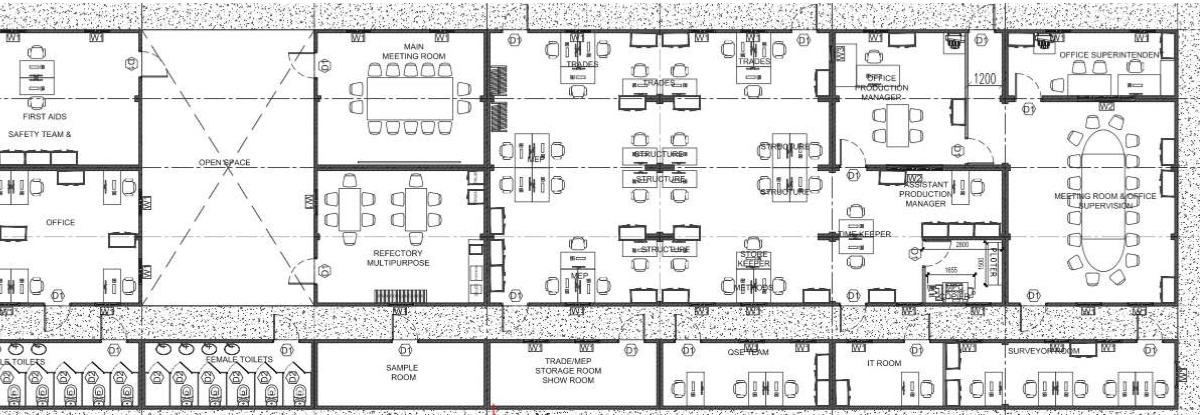

## Heavy duty yet comfortable

### Harsh environment proof

- Weather resistant even to earthquake and typhon
- Suitable for hot / cold climates
- Comfortable without air conditioning

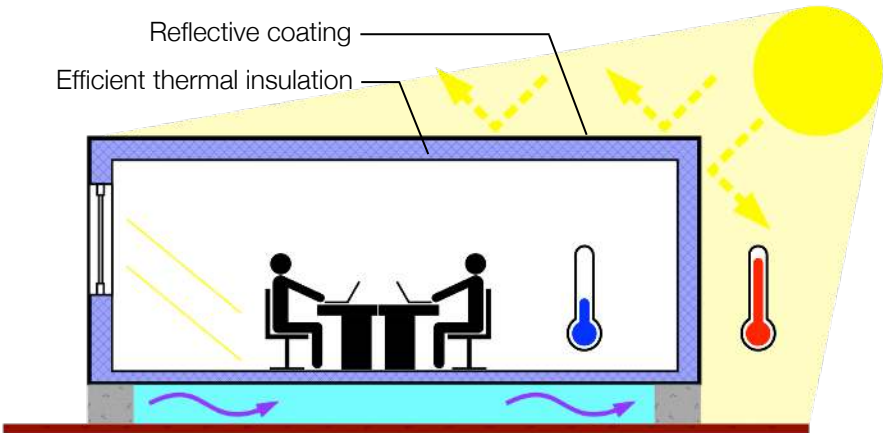



# Cost effective



## Economical facilities

Manufactured locally: no import / custom fees  
High energy efficiency: lower electricity consumption  
Rental available depending on design



# Professional solutions



## Best customer service

Responsive, client-oriented partner  
A dedicated team for your site  
Turn-key service

## Safety always comes first

Safe site conditions for you and us  
Risk assessment measures  
No compromise

# Quality on every detail

## Material Excellency

R&D development  
Validation of materials  
Innovative solutions

## Drastic Quality Control

Step by step validation process  
Quality production monitoring  
On-site control



# Environment friendly

Reduce

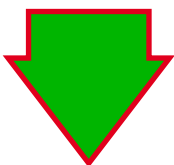

Recycle



Reuse

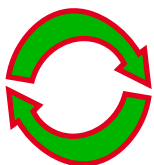

## Green solution

3R Manufacturing process: Reduce, Recycle, Reuse  
Green labeled paint and wall material  
Energy efficient solution, reduces CO2 emissions





## Among our esteemed clients:



<http://myanmar-home-design.com>

✉ [info@myanmar-home-design.com](mailto:info@myanmar-home-design.com)

☎ 09 36 131 465 - 09 767 494 821

📘 [myanmar.home.design](https://www.facebook.com/myanmar.home.design)